

REPLACE EXISTING BEND WARNING SIGN TO TSRGD DIAG. NO. 512

REMOVE EXISTING CATS-EYES ASSOCIATED WITH DOUBLE WHITE LINE ROAD MARKINGS AND RE-INSTATE CARRIAGEWAY TO SUIT. REFRESH EXISTING DOUBLE WHITE LINE MARKINGS, AND REPLACE REMOVED CATS-EYES WITH NEW ROAD STUDS

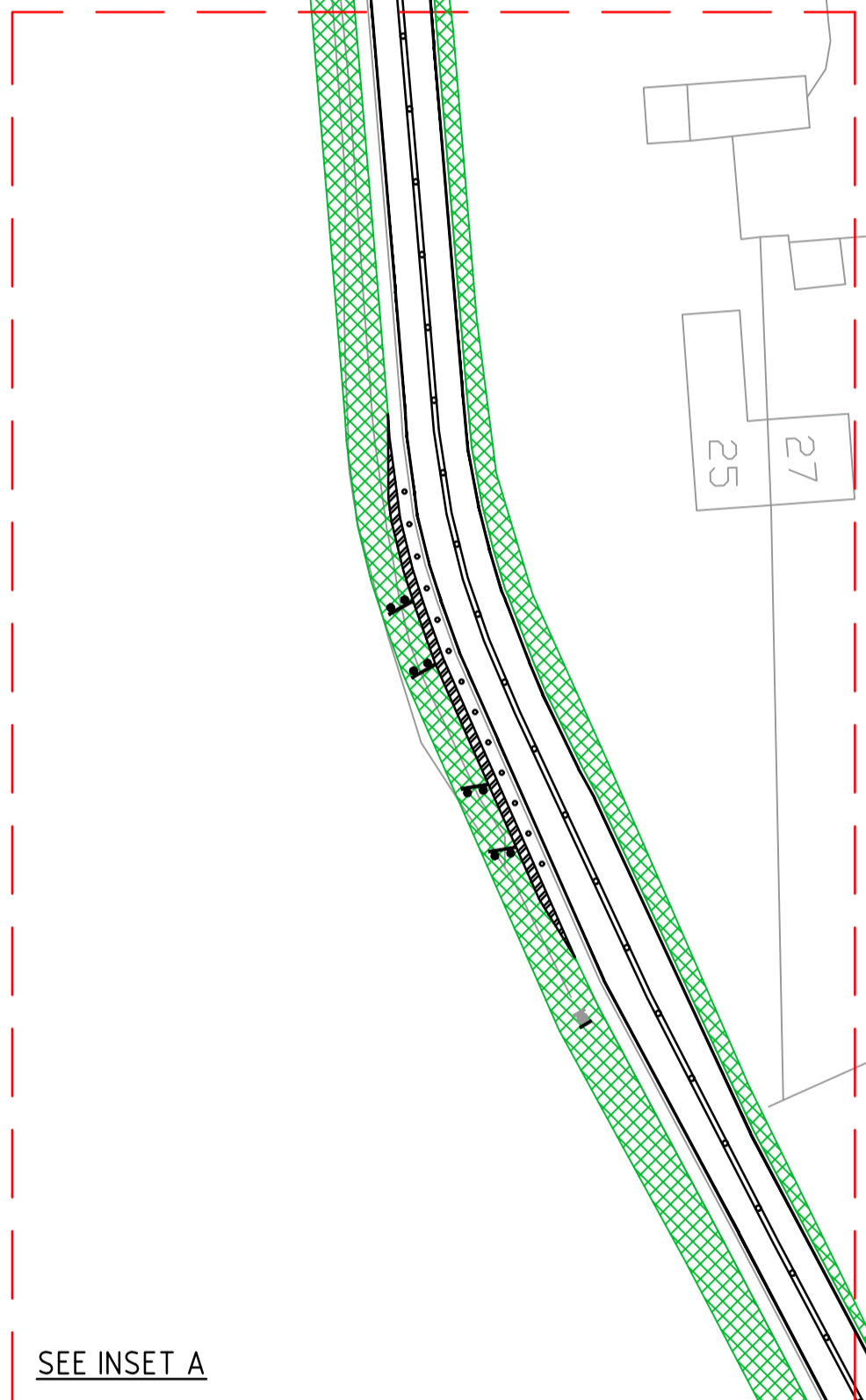

REPLACE EXISTING DIAG. 1012.1 MARKINGS WITH DIAG. 1012.3 THROUGHOUT  
 LENGTH: CONTINUOUS  
 GAP: -  
 WIDTH: 150mm

PROPOSED ARRANGEMENT  
 SCALE 1:500

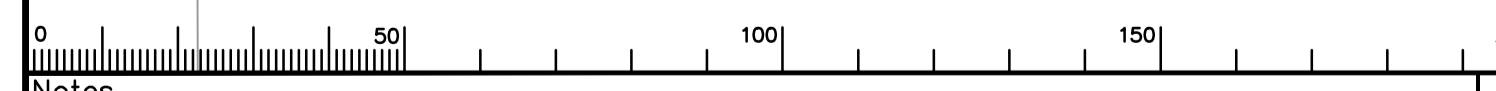

Rev.	Description	Drwn	Sig.	Date	Chkd	Sig.	Date	Appr	Sig.	Date

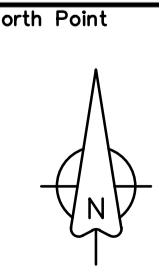

Based upon the Ordnance Survey mapping with the permission of the Controller of Her Majesty's Stationary Office © Crown copyright. Unauthorised reproduction infringes Crown copyright and may lead to prosecution or civil proceedings.  
 Surrey County Council LA 078872 2002.

Drawn by	SP	SP	MAY 17
Checked by	SP	SP	MAY 17
Approved by	JD	JD	MAY 17

Project  
 A217 REIGATE TO HORLEY (WHOLE ROUTE STUDY)  
 SITE No. 8 - A217 DOVERS GREEN ROAD, SIDLOW

Drawing  
 GENERAL ARRANGEMENT

SHEET 2 OF 2



Project No. SP0028	
Contract Sheet No.	
Drawing No. 08-002	Rev. -
Classification DRAFT	

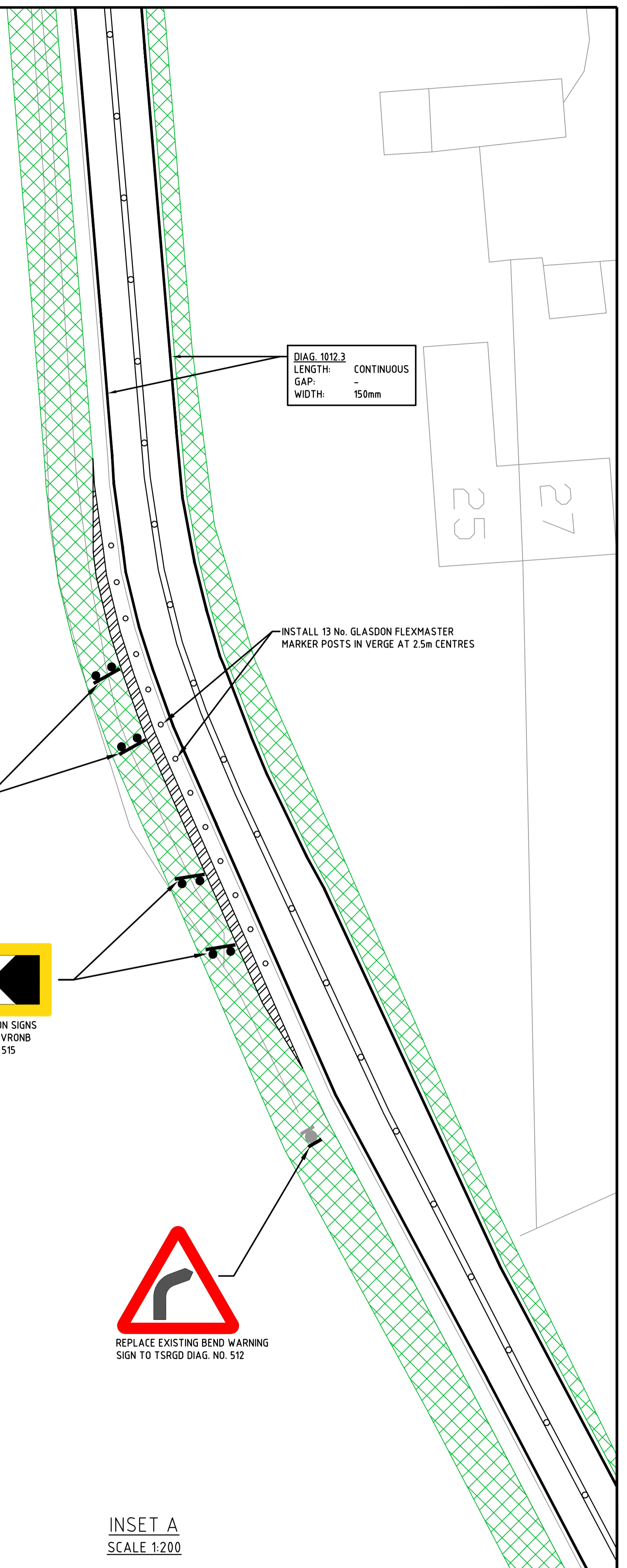

DIAG. 1012.3  
 LENGTH: CONTINUOUS  
 GAP: -  
 WIDTH: 150mm



REPLACE EXISTING CHEVRON SIGNS WITH YELLOW BACKED CHEVRON SIGNS TO TSRGD DIAG. NO. 515



REPLACE EXISTING CHEVRON SIGNS WITH YELLOW BACKED CHEVRON SIGNS TO TSRGD DIAG. NO. 515

INSTALL 13 No. GLASDON FLEXMASTER MARKER POSTS IN VERGE AT 2.5m CENTRES

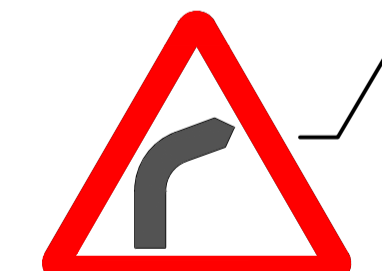

REPLACE EXISTING BEND WARNING SIGN TO TSRGD DIAG. NO. 512

INSET A  
 SCALE 1:200

This page is intentionally left blank